

ITEM 46. OTHER AUTHORITIES – PARKING – JAMISON STREET SYDNEY

TRIM RECORD NO: 2017/468118

RECOMMENDATION

It is recommended that the Committee endorse the following reallocation of parking in Jamison Street, Sydney:

- (A) On the northern side of Jamison Street, between the points 20.8 metres and 32 metres east of Clarence Street, as “No Stopping 6am-8pm Mon-Fri” and “4P Ticket 8pm-12am Mon-Fri 8am-10pm Sat, Sun & Public Holidays”;
- (B) On the northern side of Jamison Street, between the points 32 metres and 39.7 metres east of Clarence Street, as “No Stopping”; and
- (C) On the southern side of Jamison Street, between the points 30.8 metres and 42.5 metres west of York Street, as “Bus Zone 6am-10am 3pm-8pm Mon-Fri” and “Disability Parking All Other Times”.

VOTING MEMBERS FOR THIS ITEM

<i>Voting Members</i>	<i>Support</i>	<i>Object</i>
City of Sydney		
Roads and Maritime Services		
NSW Police – Sydney City LAC		
Representative for the Member for Sydney		

DECISION

BACKGROUND

On 19 December 2013, the NSW Government adopted the Sydney City Centre Access Strategy (Access Strategy). The Access Strategy will deliver a fully integrated transport network in Sydney’s City Centre that puts the customer first and meets the growing transport task. It will mean more people use public transport to access the City Centre and it will change the way people move around within it.

The Access Strategy considers all transport modes and demonstrates how light rail, buses, trains, ferries, cars, taxis, pedestrians and cyclists will interact in the heart of Sydney. The Access Strategy also provides a clear direction for how all the different transport modes will work together in the Sydney CBD to reduce congestion, provide for future growth and improve the customer experience.

There is intense competition for use of kerbside space in central Sydney. The narrow streets and short east-west blocks limit the useable kerb space that can be safely allocated to support commercial and transport functions.

As additional commercial, retail and residential floor space is constructed in and near central Sydney, and new precincts are developed, there will be increasing demands on the available kerbside space in the CBD. The consistent management and allocation of kerbside space will ensure the street network can accommodate critical business and local needs, while maintaining the efficient operation of the broader public and private transport networks.

COMMENTS

Transport for NSW (TfNSW) is implementing kerbside changes in Jamison Street to improve servicing in this area.

The kerb spaces on northern side of Jamison Street between Clarence and York Streets are currently signposted for “No Stopping”, “Loading Zone Ticket and “4P Ticket” and “Disability Parking”. TfNSW is proposing to change parking in Jamison Street to improve traffic flow in the area. The “Disability Parking” space will be relocated to the southern side as part of the proposal.

The kerb spaces on southern side of Jamison Street between Clarence and York Streets are currently signposted as “No Stopping”, “Loading Zone” and “Bus Zone”.

CONSULTATION

Transport for NSW consulted local residents, businesses and affected stakeholders. There were 750 letters sent out with no feedback received on the proposal.

FINANCIAL

All costs associated with the parking change will be borne by Transport for NSW.

ATTACHMENTS

Other Authorities – Parking – Jamison Street Sydney

Lisa McGill, Associate Director Planning CBD – Transport for NSW

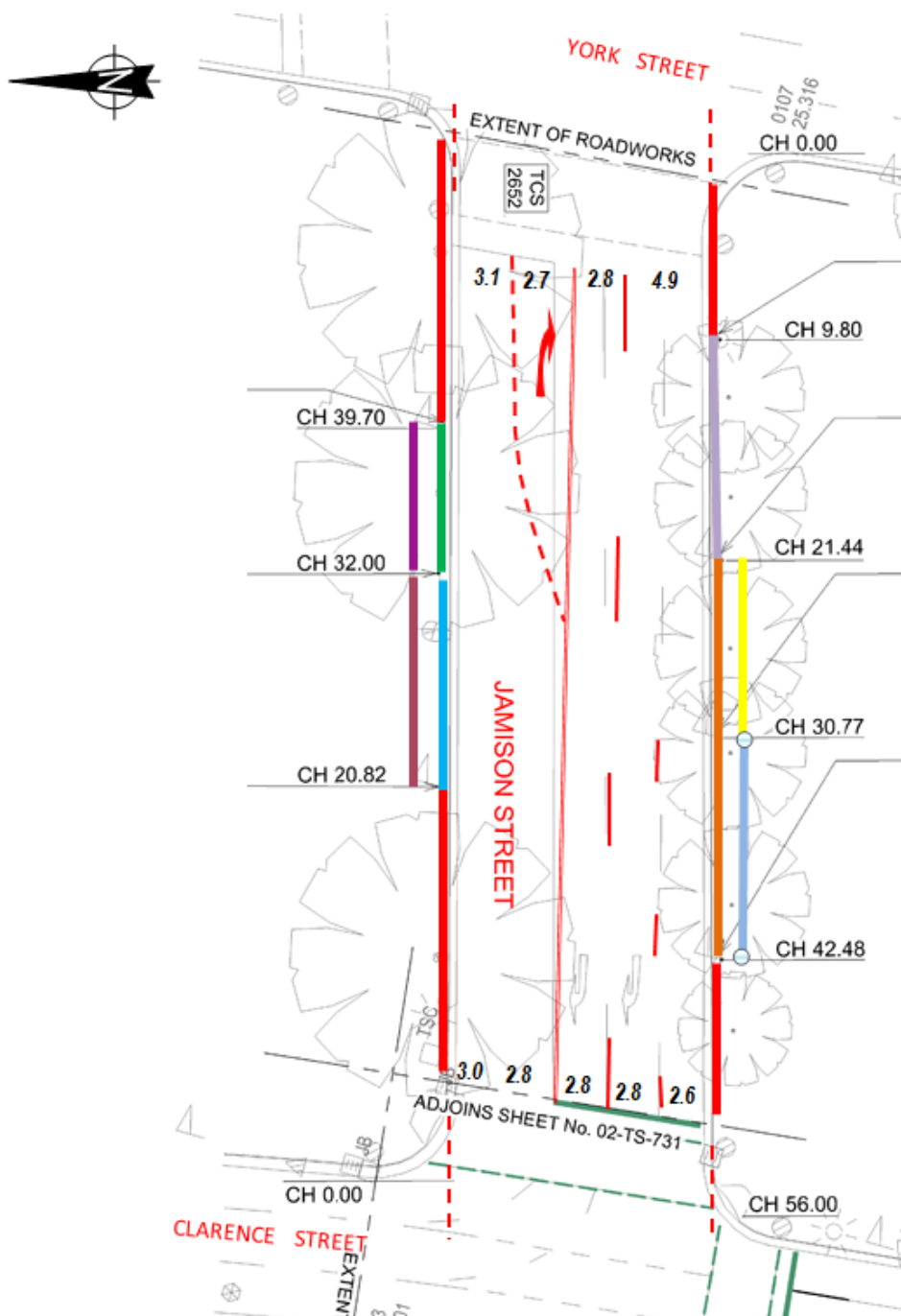

- Existing**
- █ **No Stopping**
 - █ **Loading Zone Ticket** 6am-10am Mon-Fri, **1P Ticket** 10am-6pm Mon-Fri, **4P Ticket** 6pm-10pm Mon-Fri, 8am-10pm Sat, Sun and Public Holidays
 - █ **Bus Zone** 6am-10am and 3pm-8pm Mon-Fri, **Loading Zone Ticket** 10am-3pm Mon-Fri, **4P Ticket** 8pm-12am Mon-Fri and 8am-10pm Sat, Sun and Public Holidays
 - █ **Disability Parking**
 - █ **Bus Zone** 6am-10am and 3pm-8pm Mon-Fri, **No Parking** Other Times
- Proposed changes**
- █ **No Stopping**
 - █ **No Stopping** 6am-8pm Mon-Fri, **4P Ticket** 8pm-12am Mon-Fri and 8am-10pm Sat, Sun and Public Holidays
 - █ **Bus Zone** 6am-10am and 3pm-8pm Mon-Fri, **Disability Parking** Other times
 - █ **Bus Zone** 6am-10am and 3pm-8pm Mon-Fri, **Loading Zone Ticket** 10am-3pm Mon-Fri, **4P Ticket** 8pm-12am Mon-Fri and 8am-10pm Sat, Sun and Public Holidays

